

# Meetings & Events



Estate Yountville



# One Destination. Multiple Venues. *Infinite Possibilities.*

A collection of fifteen distinctly different event venues offering over 55,000 square feet of extraordinary indoor and outdoor settings. Your guests will enjoy the choice of a refined and relaxed lush-meets-luxe hotel experience at Vintage House or a vibrant, modern escape at Hotel Villagio. With unparalleled service and exquisite attention to detail, your event will truly be one to remember.



Estate Yountville

THE PAVILION

Estate Yountville | MEETINGS & EVENTS



Estate Yountville

# Our Experiences

- |                             |                                  |                       |
|-----------------------------|----------------------------------|-----------------------|
| ① Hotel Villagio            | ④ Hot Air Balloon Departure Area | ⑦ Wylde (Fall 2025) ✕ |
| ② Rendez Veuve Spa Entrance | ⑤ Fitness Center                 | ⑧ Vintage House       |
| ③ The Villa                 | ⑥ Bottega & Ottimo ✕             | ⑨ Clementine ✕        |

TASTING ROOMS = 🍷



# Our Venues

- |                |                   |                |
|----------------|-------------------|----------------|
| Ⓐ The Vineyard | Ⓒ The Social      | Ⓔ The Pavilion |
| Ⓑ The Grove    | Ⓓ The Barrel Room | Ⓕ Clementine   |

THE IDEAL  
SETTING FOR



Grand Event



Celebration



Reception



Banquet

THE PAVILION

# The Pavilion

When you plan a meeting at The Estate Yountville, our surroundings serve as an instrument of inspiration. The Pavilion comes to life with two stunning adjoining outdoor spaces each with distinctly different settings. Combined, this unforgettable Napa Valley venue provides more than 15,000 square feet of sculpted terrace gardens and lush outdoor event spaces.



# The Pavilion

## SITE MAP

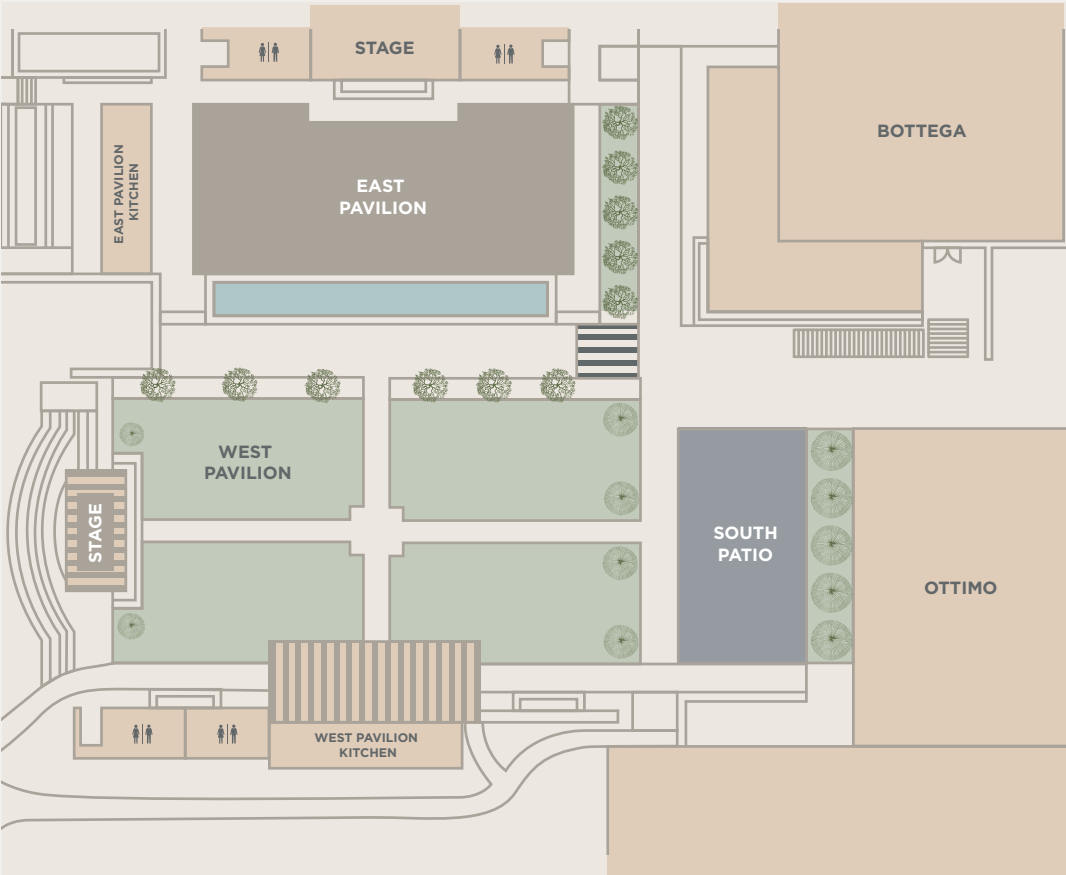

### THE PAVILION

PAVILION	SQFT
Total	15,235
EVENT SET-UPS	OCCUPANCY
Reception	1,200
Plated Brunch / Lunch / Dinner	680

EAST PAVILION	SQFT
98' x 40'	3,920
EVENT SET-UPS	OCCUPANCY
Reception	400
Grand Event	220
Plated Brunch / Lunch / Dinner	220

SOUTH PATIO	SQFT
73' x 34'	2,482
EVENT SET-UPS	OCCUPANCY
Reception	100
Plated Brunch / Lunch / Dinner	60

WEST PAVILION	SQFT
121' x 73'	8,833
EVENT SET-UPS	OCCUPANCY
Reception	700
Grand Event	450
Plated Brunch / Lunch / Dinner	400

THE IDEAL  
SETTING FOR



Grand Event



Celebration



Reception



Banquet



After Hours

THE BARREL ROOM

# The Barrel Room

This evocative room is centrally located within The Estate Yountville property and combines the rustic character of the original 1870 Groezinger Winery with the exquisite style and amenities of a modern event experience. Grand wrought iron chandeliers and state-of-the-art theatrical and task lighting, together with several interior perimeter accent uplights, enhance this 2,040 square foot, ballroom-style space with glowing warmth from the floor to the 36-foot beam and rafter ceiling.



# The Barrel Room

SITE MAP

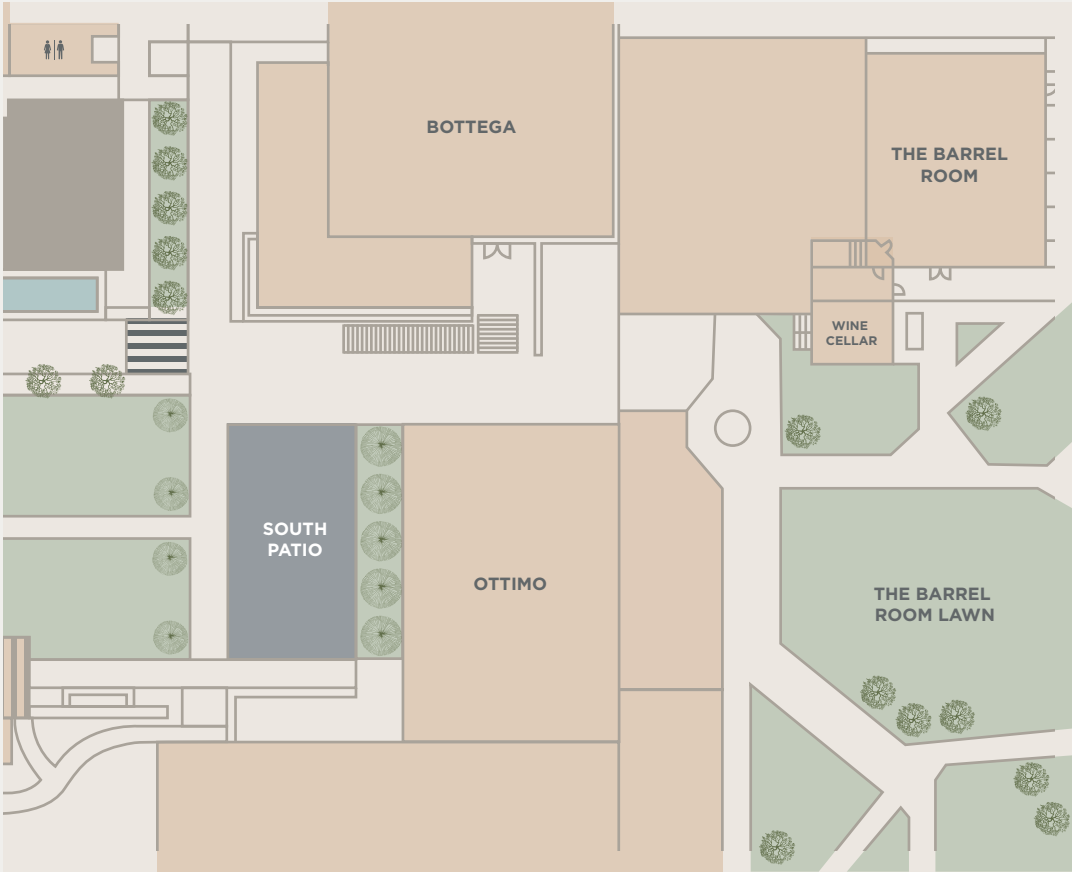

THE BARREL ROOM

BARREL ROOM

SQFT

61' x 34'

2,040

EVENT SET-UPS

OCCUPANCY

Reception

200

ROUNDS *(72" rounds of 12 people)*

Full Max 160

Dance Floor / DJ / Bar 100

Buffet / Dance Floor / DJ / Bar 80

Classroom 96

Theater 170



THE IDEAL  
SETTING FOR



Grand Event



Meeting



Reception



Banquet



After Hours

THE SOCIAL

# The Social

The Social offers nearly 8,750 square feet of indoor and outdoor event space that seamlessly transition to one another. The Napa-chic farm house architecture is accented with full height window walls that open to the adjoining outdoor areas. This one-of-a-kind event venue features an expansive ballroom with dual-sided fireplace, lush event lawn with water features, stunning front patio and open air courtyard bar and lounge.



# The Social

## SITE MAP

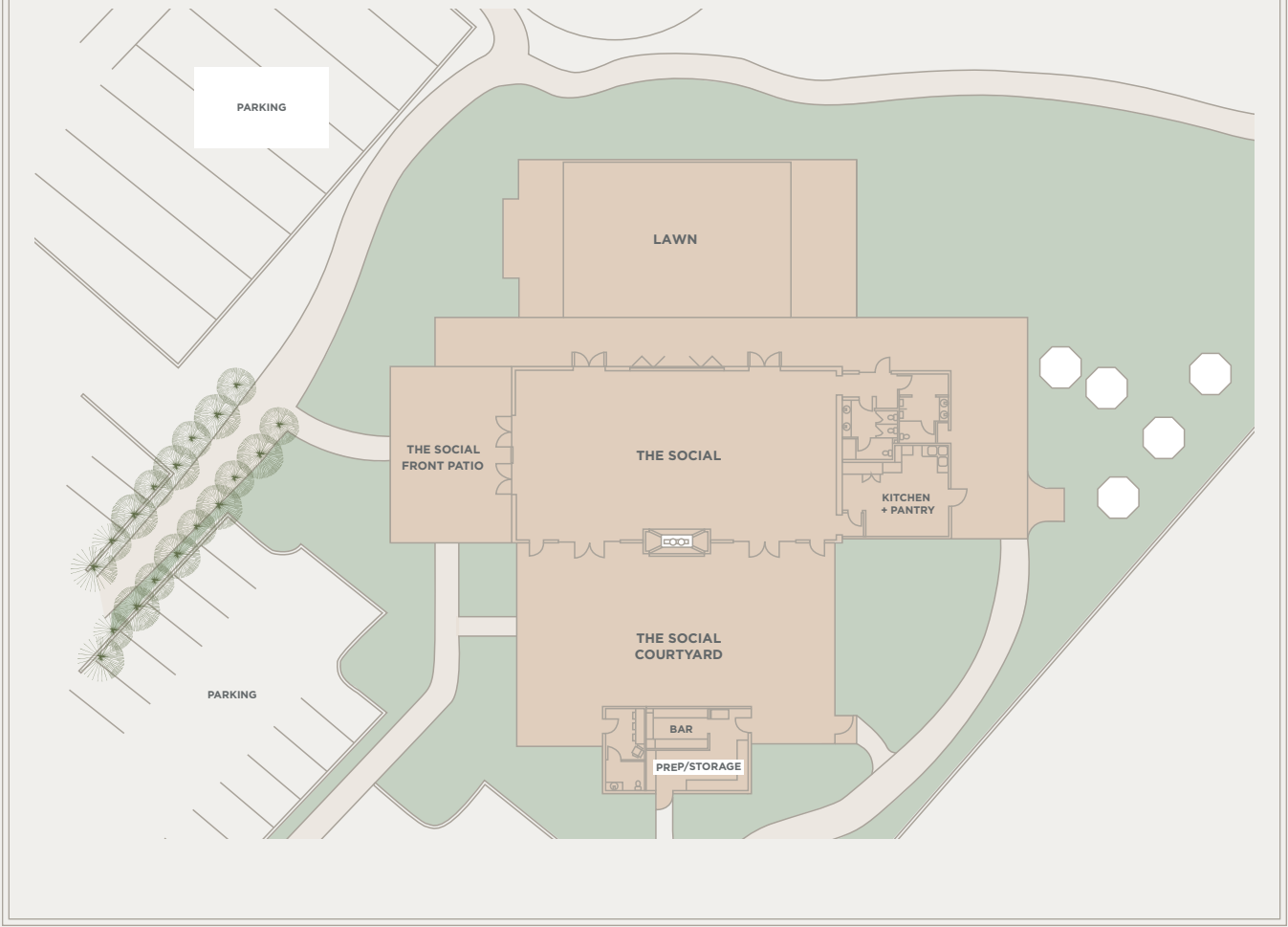

THE SOCIAL	SIZE (LXW)	SQFT	THEATER	CLASSROOM	BANQUET	RECEPTION	CEREMONY
The Social (Indoors)	72' x 38'	2,767	250	120	180	-	-
The Social Front Patio	28' x 26'	728	-	-	-	-	-
The Social Court-yard	47' x 36'	1,880	-	-	72	160	-
The Social Lawn	74' x 45'	3,375	-	-	200	250	180
Total Social	-	8,750	-	-	-	300	-

(72" rounds of 12 people)

THE IDEAL  
SETTING FOR



Exclusive Event



Celebration



Reception



Banquet

THE VINEYARD

# The Vineyard

Immerse yourself in all that is authentic and beautiful in Napa Valley. Featuring a tranquil water feature in a picturesque vineyard setting, The Vineyard accommodates a variety of event sizes, ranging from family style meals up to 40 people in one table to banquet rounds of 60. Receptions available for up to 150 guests.



# The Vineyard

## SITE MAP



THE VINEYARD	SIZE (LXW)	SQFT	BANQUET	RECEPTION	CEREMONY
The Vineyard Lawn	45' x 25'	1,125	72	90	120

(72" rounds of 12 people)



# Small Meeting Spaces

THE FOUNDER'S ROOM

# Collaborate & Innovate

AT ESTATE YOUNTVILLE

Along with grand venues which include The Social, The Pavilion, and The Barrel Room, Estate Yountville offers a selection of smaller spaces that are perfect for hosting private events and meetings.

THE FOUNDER'S ROOM	SIZE (LXW)	SQFT	
The Founder's Boardroom	14' x 27'	380	
The Founder's Lounge	19' x 27'	486	
Total Founder's Room	33' x 27'	900	Boardroom-style seating for up to 16 guests

THE GEORGE	SIZE (LXW)	SQFT	
The George Boardroom	14' x 29'	406	Boardroom-style seating for up to 16 guests
The George Patio	8' x 23'	184	

THE PANORAMA	SIZE (LXW)	SQFT	
The Panorama Boardroom	11' x 29'	319	Boardroom-style seating for up to 16 guests

THE NEXUS	SIZE (LXW)	SQFT	
The Nexus Boardroom	11' x 17'	187	Boardroom-style seating for up to 16 guests

# The Grove

## SITE MAP

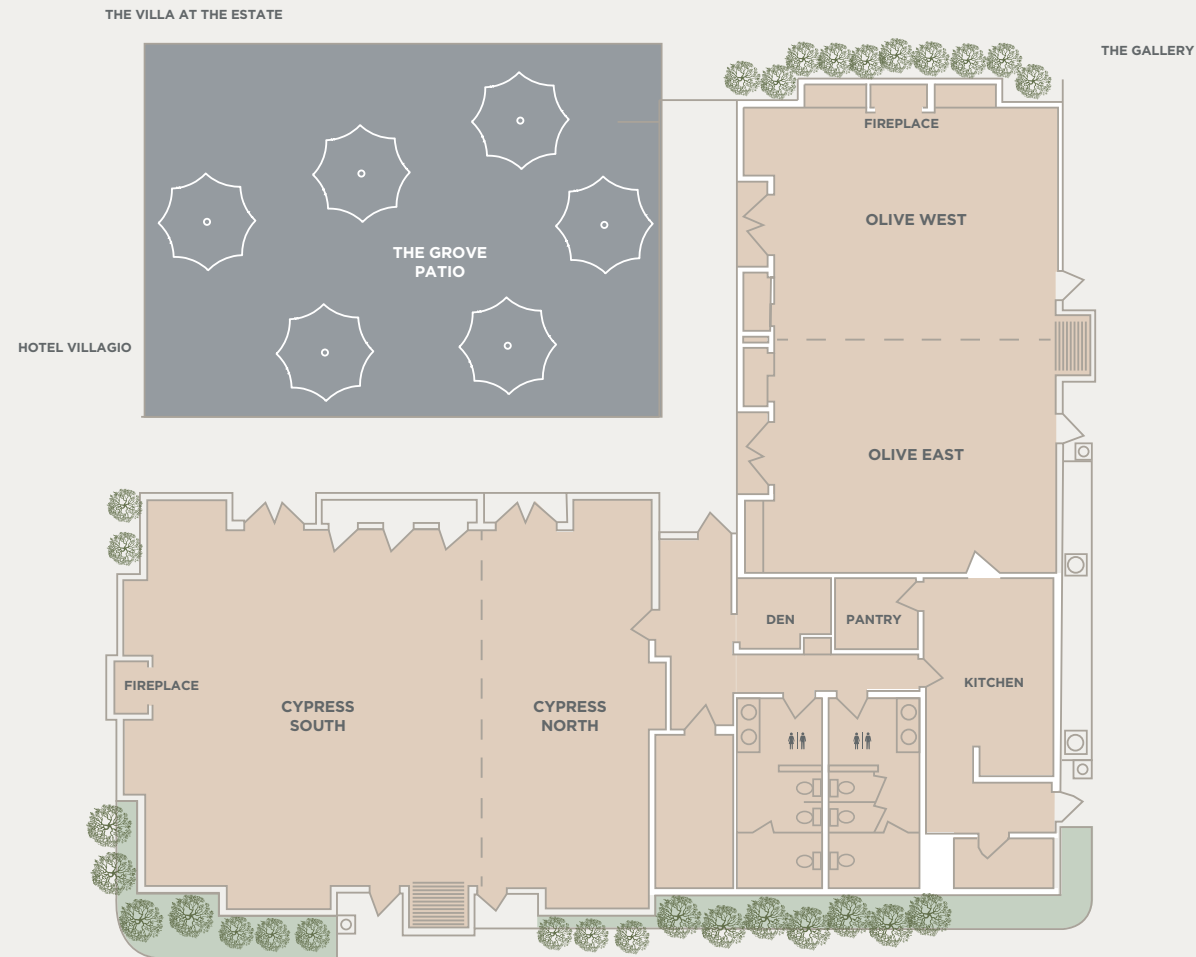

THE GROVE	SIZE (LXW)	SQFT	U-SHAPE	CRESCENTS	CLASSROOM	BANQUET	RECEPTION
Cypress South	29' x 36'	1,065	24	24	36	45	60
Cypress North	22' x 36'	797	20	12	24	65	80
Total Cypress	50' x 35'	1,862	34	54	72	110	140
Olive East	23' x 28'	663	14	24	24	35	35
Olive West	23' x 28'	663	14	24	24	45	50
Total Olive	47' x 28'	1,322	30	36	63	90	100
THE GROVE PATIO	46' x 26'	1,196	Café-style seating for up to 68 guests				

A close-up photograph of two crostini on a rustic wooden cutting board. Each crostini is topped with a poached egg, a generous portion of smoked salmon, and garnished with fresh rosemary and a sprinkle of black pepper. A small wooden honey dipper with a pool of honey sits on the board between the two crostini. The background is softly blurred, showing more of the wooden surface and some greenery.

# Event Catering

At Estate Yountville, food and the exquisite execution of its service are our passion.

The approach we take is decidedly different. Our Estate culinary experts are solely focused on crafting menus with locally sourced items, and on creating culinary experiences which are tailored to exceed the personal dining expectations of you and your guests. While the core of our signature menus is California cuisine, our culinarians have the flexibility to produce menus of a much broader spectrum, and delight in customizing menus that reflect your own ideas and personal style. We await the opportunity to create unforgettable moments for you and your guests, drawing from all that our bountiful region has to offer. Welcome to a grand exploration, the alluring centerpiece of Yountville - a place where splendid relaxation meets exceptional taste, and every detail is thoughtful. This is Estate Yountville.



Whether a corporate meeting or a grand celebration, it is sure to be an event to remember.

For meetings and events, please contact 707.945.4545 or [leads@estateyountville.com](mailto:leads@estateyountville.com)



Estate Yountville

Estate Yountville

6481-6541 WASHINGTON STREET  
YOUNTVILLE, CA 94599

707.945.4546 | [THEESTATEYOUNTVILLE.COM](http://THEESTATEYOUNTVILLE.COM)